

BVE-LW 200 TO 1000

Single heat exchanger - Large area for HP



The BVE-W series tanks are specially designed for primary circuit solar systems. They are equipped with a heat exchanger. The tank and the exchanger are made of stainless steel 316L. These tanks are to be placed on the ground.



Description

- Enamelled steel sanitary hot water storage tank*, equipped with one heat exchanger with a large area.
- Tank enamelling inside treatment according to DIN 4753-3 and UNI 10025. Protection by magnesium anode.
- Rigid PU insulation 50 to 70 mm thick, zipped PVC cover finish, removable.
- Optional electric back-up on 1 1/2" connection above the heat exchanger.
- External casing classified as standard M1 fire.
- 3 years warranty, electric part 2 years warranty.

* Sanitary water in compliance with French sanitary regulations particularly DTU 60.1



BVE-LW 200, 300, 500, 800 and 1000 liters

	Model	200 L	300 L	500 L	800 L	1000 L
Reference		BVE0200LW	BVE0300LW	BVE0500LW	BVE0800LW	BVE1000LW
Total capacity (liters)		181	276	429	750	933
Weight empty (kg)		105	151	211	277	342
Rigid PU insulation ejected (mm)		50	50	50	70	70
Heat exchanger surface (m ²)		2.62	3.77	6	6.55	8.20
Heat exchanger capacity (L)		13	18	29	43	54
Heat exchanger output (60-80°C) (kW)		63	90	144	157	197
Heat exchanger continuous flow rate (60-80°C) (l/h)		1545	2223	3538	3863	4836
Heat loss ΔT 45K (kWh/24h)		1.5	1.7	2.5	3.2	3.5
Energy efficiency class		B	B	C	C	C
Maximum tank / heat exchanger working-temperature (°C)		95	95	95	95	95
Max tank operating pressure (bar)		10	10	10	8	8
Max working heat exchanger pressure (bar)		6	6	6	6	6

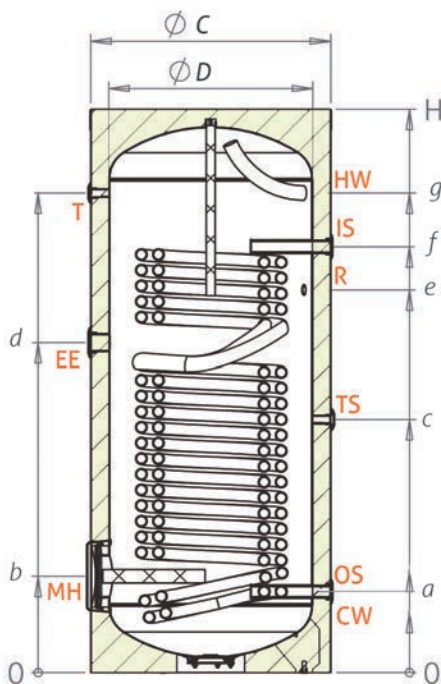

Model	ØC	ØD	H	a	b	c	d	e	f	g
200	600	500	1230	242	287	612	694	735	982	982
300	600	500	1760	242	287	732	1012	1088	1222	1512
500	700	600	1900	238	283	863	993	1184	1488	1658
800	990	850	1770	331	459	769	994	1025	1206	1372
1000	990	850	2100	331	459	846	1154	1262	1361	1727

Dimensions (mm)

SYRIUS SOLAR INDUSTRY
15 rue du Perpignan - ZAC Descartes
34880 Lavérune - France

+33 (0) 4 67 82 00 18
contact@syrius-solar.fr

SAS with capital of € 156 800 - RCS Montpellier 794 797 753 00041

	Model	
Outlet/Inlet tube	200-500	800-1000
MH Manhole	Ø180	Ø300
CW Cold water inlet	1" F	1 1/2" F
HW Hot water outlet	1" F	1 1/2" F
OS Lower HE outlet	1" F	1 1/2" F
IS Lower HE inlet	1" F	1 1/2" F
TS Sensor pocket 1	1/2" F	1/2" F
EE Electric element	1 1/2" F	1 1/2" F
R Recirculation	3/4" F	3/4" F
T Thermometer	1/2" F	1/2" F

Storage tank 3 years warranty

Certifications

Tank enamelling inside treatment according to DIN 4753-3 and UNI 10025
Made in European Union



www.syrius-solar.com

