

BVE-WW 800 TO 2000

Double heat exchanger



The BVE-WW series tanks are specially designed for primary circuit solar systems. They are equipped with two heat exchangers.

The tank and the heat exchangers are made of enamelled steel. These tanks are to be placed on the ground, and are generally used in combination with solar production (on the bottom heat exchanger) and back-up by a boiler or heat pump (on the top heat exchanger).



Description

- Enamelled steel sanitary hot water storage tank*, equipped with two heat exchangers.
- Tank enamelling inside treatment according to DIN 4753-3 and UNI 10025. Protection by 2 magnesium anodes.
- Polyester fiber insulation 100 mm thick, zipped PVC cover finish.
- Optional electric back-up on 1 1/2" connection above the heat exchanger.
- External casing classified as standard M1 fire.
- 5 years warranty, electric part 2 years warranty.

* Sanitary water meeting the French standard according to decree N° 89-3 of 03/01/89



BVE-WW 800 to 2000 liters

	Model	800 L	1000 L	1500 L	2000 L
Reference		BVE0800WW	BVE1000WW	BVE1500WW	BVE2000WW
Total capacity (liters)		738	930	1390	1950
Weight empty (kg)		222	239	350	542
Polyester fiber insulation (mm)		100			
Heat exchanger surface S1/S2 (m ²)		2.7 / 1.6	3.0 / 1.6	3.4 / 1.8	4.6 / 2.8
Heat exchanger volume S1/S2 (L)		15.2 / 9.3	21.0 / 9.3	19.5 / 10.4	28.1 / 16.9
Heat exchanger power S1/S2 (kW) at *60-80°C		68 / 40	75 / 40	88 / 47	120 / 73
Rate of flow heat-exchanger S1/S2 (m ³ /h)		2.9 / 1.7	3.2 / 1.7	3.8 / 2.0	5.2 / 3.1
Domestic hot water production S1/S2 at *60-80°C (m ³ /h)		1.7 / 1.0	1.8 / 1.0	2.2 / 1.2	2.9 / 1.8
Pressure loss S1/S2 (mbar)		236 / 52	329 / 52	499 / 80	1019 / 233
Flange (Ø mm)		180 / 120		290 / 220	
Energy efficiency class					C
Maximum working-temperature (°C)					95
Max tank operating pressure (bar)		10		8	
Max working heat exchanger pressure (bar)					10

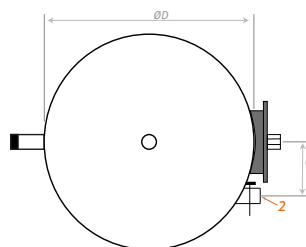
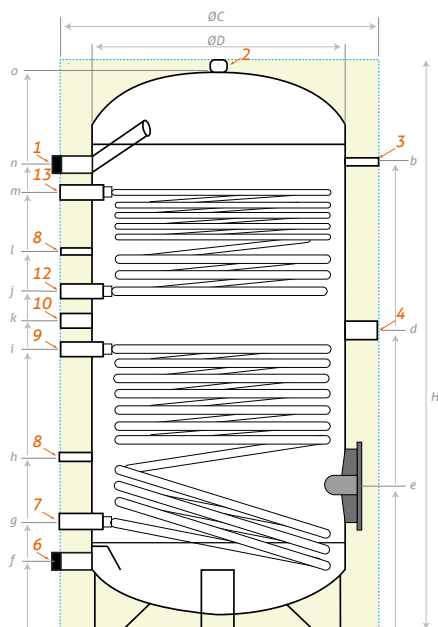

Outlet/Inlet tube	Model	
	800-1000	1500-2000
1 Hot Water outlet	1 1/4"	1 1/2"
2 Anode	1 1/2"	1 1/2"
3 Probes	1/2"	1/2"
4 Electric element	1 1/2"	1 1/2"
6 Cold Water inlet	1 1/4"	1 1/2"
7 Heat exchanger outlet S1	1 1/4"	1 1/4"
8 Thermostat	1/2"	1/2"
9 Heat exchanger inlet S1	1 1/4"	1 1/4"
10 Recirculation	1"	1"
12 Heat exchanger outlet S2	1 1/4"	1 1/4"
13 Heat exchanger inlet S2	1 1/4"	1 1/4"

Storage tank 5 years warranty

Certifications

Tank enamelling inside treatment according to DIN 4753-3 and UNI 10025
Made in European Union



Model	ØC	ØD	H	b	d	e	f	g	h	i	j	k	l	m	n	o	q
800	990	790	1875	1500	980	470	240	365	565	905	1085	995	1235	1400	1500	1810	200
1000	990	790	2205	1830	1220	470	240	380	600	1120	1345	1235	1495	1660	1830	2140	200
1500	1200	1000	2185	1820	1230	515	280	415	525	1125	1315	1220	1410	1720	1870	2120	230
2000	1300	1100	2470	2000	1340	550	260	400	660	1205	1425	1315	1485	1870	1990	2405	230

Dimensions (mm)

SYRIUS SOLAR INDUSTRY
15 rue du Perpignan - ZAC Descartes
34880 Lavérune - France

+33 (0) 4 67 82 00 18
contact@syrius-solar.fr

SAS with capital of € 156 800 - RCS Montpellier 794 797 753 00041

www.syrius-solar.com

